

FIRST AVENUE

MAIN STREET

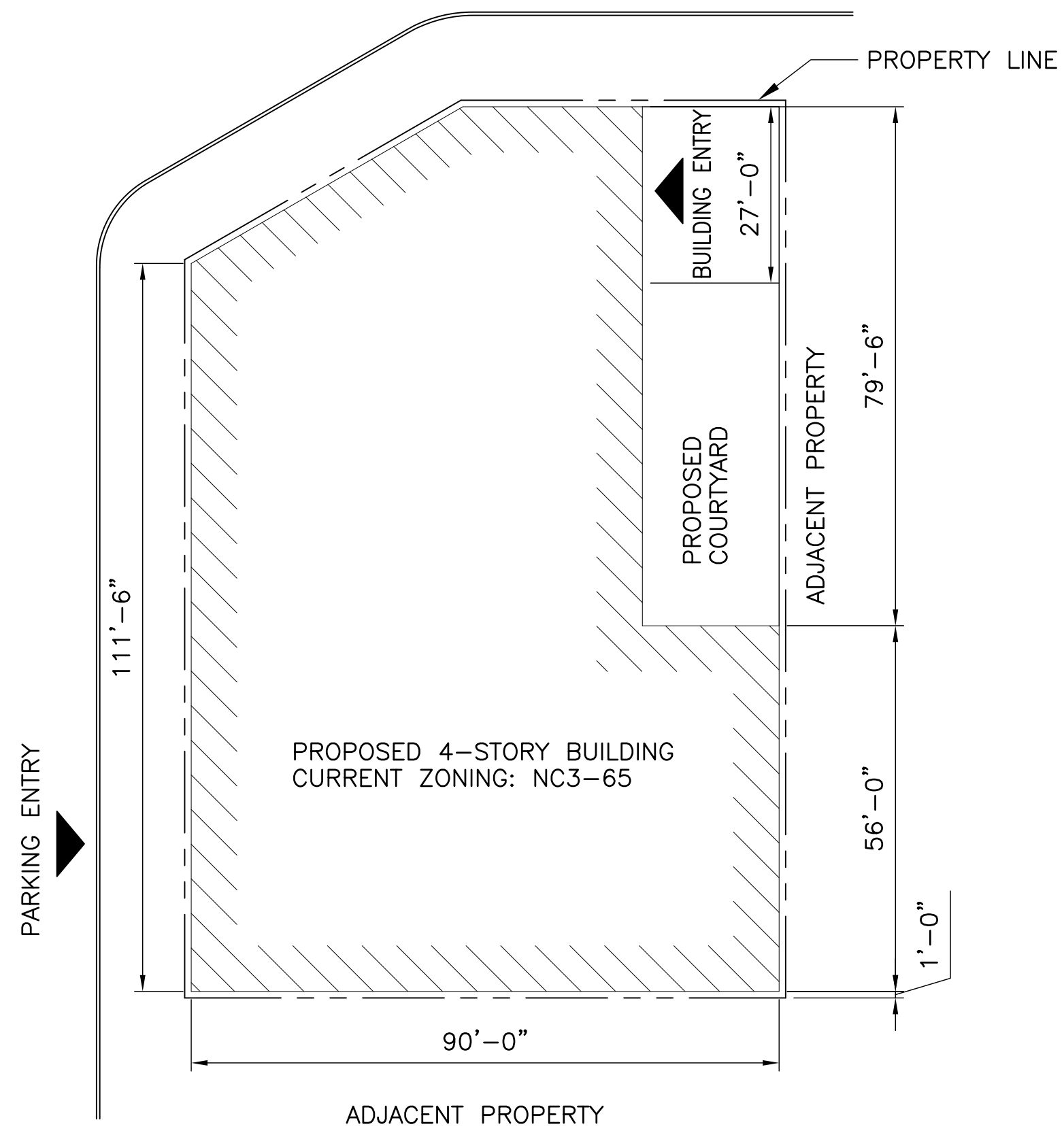

LEGAL DESCRIPTION:
 LOTS 1, 2, 3, AND 4, BLOCK 1, OF AN ADDITION TO THE CITY OF SEATTLE, AS LAID OFF BY D.T. DENNY, ACCORDING TO THE PLAT THEREOF, RECORDED IN VOLUME 1 OF PLATS, PAGE 1, IN KING COUNTY, WASHINGTON

PROPERTY ADDRESS:
 123 FIRST AVENUE
 SEATTLE WASHINGTON 98123

PARCEL NUMBER:
 000000-0000

PROPERTY OWNER:
 JOHN DOE
 123 MAIN ST.
 SEATTLE, WA 98123



CUSTOMER REQUIREMENTS

DOCUMENT CHECKLIST:

- STREET DESIGNATIONS AND PROJECT ADDRESS
- NORTH ARROW
- SCALE BAR
- PROPERTY LINES
- BUILDING FOOTPRINT AND DIMENSIONS
- PROPOSED OR EXISTING EASEMENT AREAS

LEGAL SITE PLAN

SCALE 1"=20'

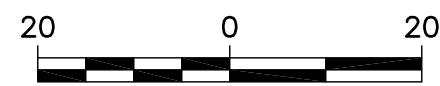

SCALE: 1"=20'

ONE INCH AT FULL SIZE	REVISIONS	REV	DATE	IMAGE	DESCRIPTION	ENDORSEMENTS			PROJECT TYPE	LEGAL SITE PLAN	SHEET	
		DRAWN BY: CB CHECKED BY: WORK ORDER #:	DATE 10/15/2017	APPROVED: APPROVED FOR SEATTLE CITY LIGHT		PROJECT NAME	LEGAL SITE PLAN		1		OF	1
<small>THIS DRAWING IS THE PROPERTY OF THE CITY OF SEATTLE AND ITS SEATTLE CITY LIGHT DEPARTMENT. IT IS PRODUCED SOLELY FOR THE USE BY SEATTLE CITY LIGHT AND OTHER CITY DEPARTMENTS. THE USE, REPRODUCTION, AND TRANSFER OF THIS DRAWING AND/OR ANY INFORMATION CONTAINED IN THE DRAWING REQUIRES THE WRITTEN PERMISSION OF SEATTLE CITY LIGHT.</small>						PROJECT ENGINEER SHEET CONTENTS		PROJECT ADDRESS	LEGAL SITE PLAN	WORK ORDER NO.-TASK		
						QUARTERSECTION NUMBER(S) SECTION / TOWNSHIP / RANGE		APPROVED FOR SEATTLE CITY LIGHT	PROJECT ADDRESS	LEGAL SITE PLAN	CITY	DRAWING NO.
												0