

# PINEHURST WAY NE AND NE 117TH ST INTERSECTION IMPROVEMENT

Spring 2019

## PROJECT DESCRIPTION

This project will redesign the intersection at Pinehurst Way NE and NE 117th St.

Pinehurst Way NE and NE 117th St contains two north-south arterials (Pinehurst Way NE and 15th Ave NE) crossed by an east-west non-arterial (NE 117th St), creating a complex junction of three intersections. NE 117th St is also a future neighborhood greenway route that will connect people walking and biking between Olympic Hills, Pinehurst, Maple Leaf, and the future Northgate Link light rail station.

Our primary goals are to **improve safety and mobility** along the corridor, so that all travelers may have a safer and more comfortable experience.

## PROJECT BACKGROUND

Upgrades to Pinehurst Way NE and NE 117th St were first identified by Hazel Wolf K-8 School and neighborhood residents. Following a successful Your Voice, Your Choice application to design improvements at this intersection, we studied traffic data at this location, which showed a pattern of collisions that could be resolved through a redesign of the intersection. We prioritize these “high collision locations” and put resources toward improving them as soon as possible. Improvements at this intersection for all travel modes also allow us to provide a safer and more convenient walking and biking connection to Hazel Wolf K-8 and a connection along the future Pinehurst Neighborhood Greenway.

## SCHEDULE AND FUNDING

The Pinehurst Way NE and NE 117th St intersection improvement is funded through the Levy to Move Seattle and the WSDOT Safe Routes to School program. Project design will continue throughout 2019 with construction scheduled to begin as soon as summer 2020.

## PROJECT FEATURES

- Install new traffic signals to improve pedestrian and bike crossings and improve traffic flow on Pinehurst Way NE and 15th Ave NE
- Re-configure intersection layout, install marked crosswalks and medians to provide safe and comfortable crossings
- Restrict turning movements to reduce congestion and potential conflicts
- Create a connection for the future Pinehurst Neighborhood Greenway and the future Northgate Link light rail station
- Construct a new block of sidewalk on the south side of NE 117th St between Roosevelt Way NE and 12th Ave NE
- Reduce the number of collisions
- Increase safety and predictability for all travelers



*Existing visibility, channelization and crossing challenges: northbound on Pinehurst Way NE and NE 117th St*

These projects are funded by the 9-year Levy to Move Seattle, approved by voters in 2015. Learn more about the levy at [www.seattle.gov/LevytoMoveSeattle](http://www.seattle.gov/LevytoMoveSeattle).



Seattle  
Department of  
Transportation

VISION  
ZERO  
SAFER STREETS FOR SEATTLE

The Levy to  
MOVE SEATTLE

# PINEHURST WAY NE AND NE 117TH ST INTERSECTION IMPROVEMENT

## EXISTING INTERSECTION AND CHALLENGES

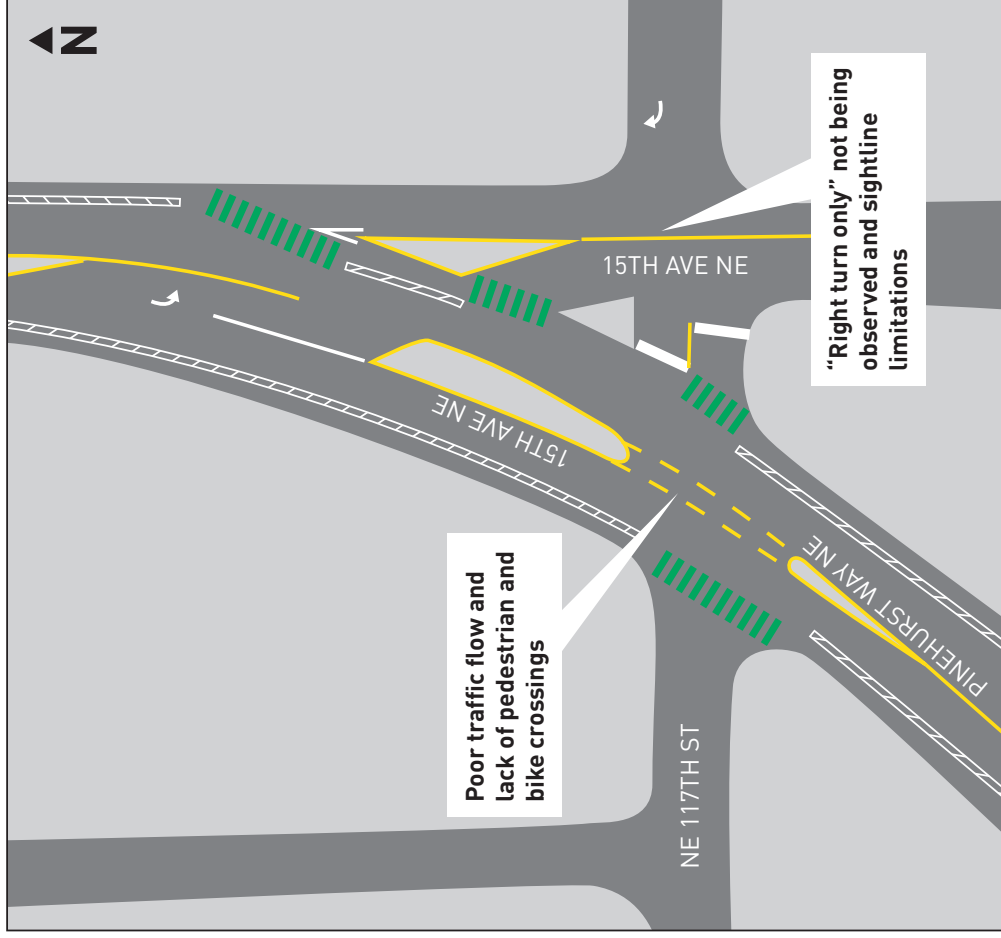

## PROPOSED INTERSECTION DESIGN AND USER BENEFITS

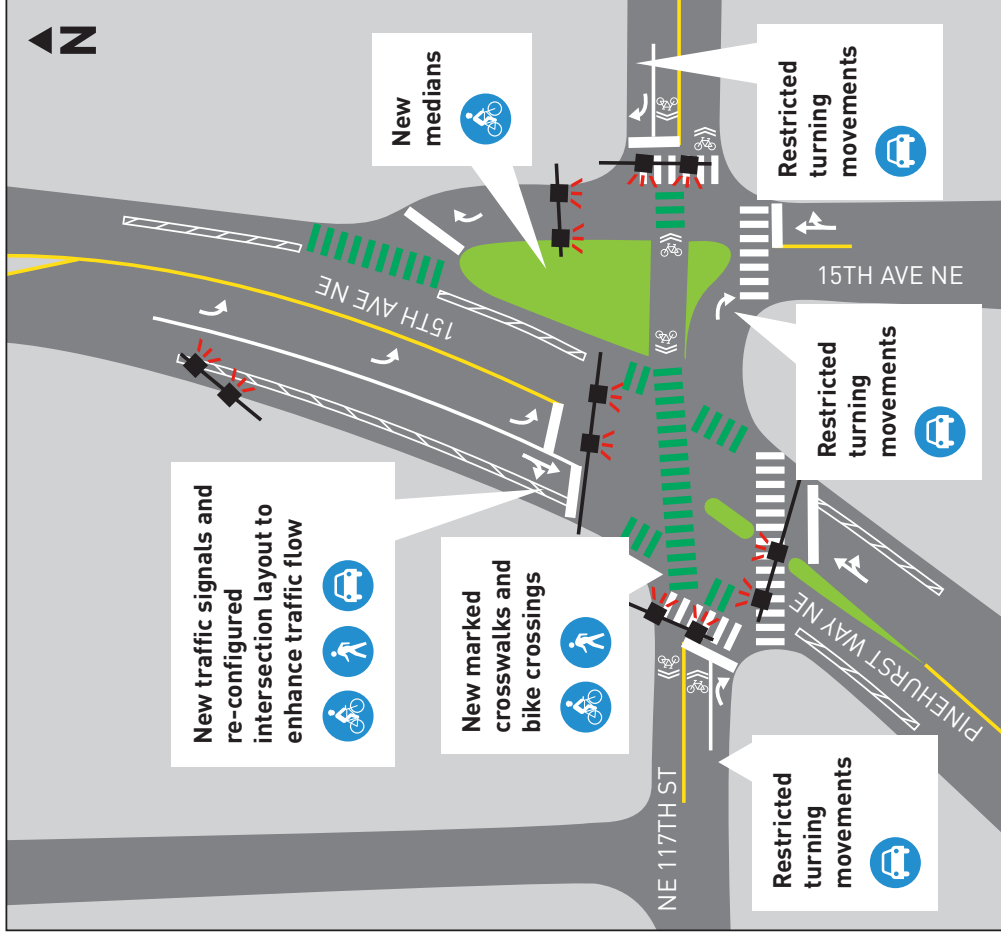

## PROJECT INFORMATION & CONTACT

### Your Voice, Your Choice Projects

[www.seattle.gov/transportation/projects-and-programs/programs/pedestrian-program/](http://www.seattle.gov/transportation/projects-and-programs/programs/pedestrian-program/)  
[pinehurst-way-ne-and-ne-117th-st-intersection-and-sidewalk-project@dot.ne117thpinehurst@seattle.gov](mailto:pinehurst-way-ne-and-ne-117th-st-intersection-and-sidewalk-project@dot.ne117thpinehurst@seattle.gov) | (206) 316-2549